



Forward Curved Utility Blowers

Model FCF

Model FCF is a forward curved utility blower. These all purpose blowers provide an economical solution to many air moving requirements.



Options/Accessories

- Backdraft Dampers
- Inlet/Outlet Screens
- Belt Guard
- Corrosion Resistant Finishes
- Vibration Isolation
- Drain
- Heat Slinger
- Shaft Seal

Model FCF

- Forward curved single width, single inlet
- Seven sizes with a capacity up to 14,500 CFM
- Arrangement 10
- CCW rotation standard
- Attractive green enamel finish
- Access panels on both sides for convenient servicing
- Keyed shafts on both ends
- Belt Drive

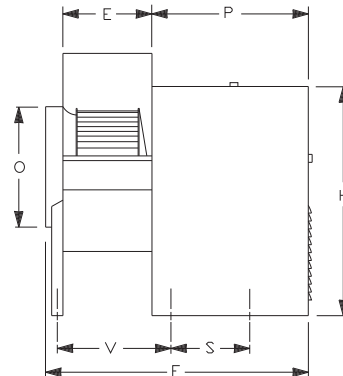
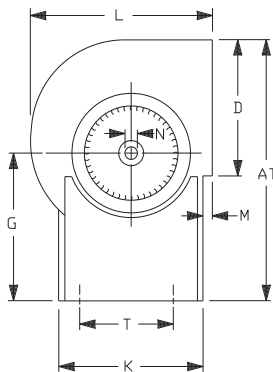

Typical drawing for dimensional purposes only, which is correct within limits suitable for normal installation requirements, and does not necessarily show actual construction.

MODEL	AT	D	E	F	G	H	K	L	M
FCF10	24 ¹ / ₁₆	11 ³ / ₈	9 ³ / ₁₆	29 ¹ / ₁₆	15 ¹ / ₁₆	21 ⁵ / ₁₆	13 ³ / ₁₆	16 ³ / ₄	1 ³ / ₈
FCF12	26 ⁹ / ₁₆	13 ⁷ / ₁₆	9 ³ / ₁₆	29 ¹ / ₁₆	15 ¹ / ₁₆	21 ⁵ / ₁₆	13 ³ / ₁₆	19 ¹ / ₂	2 ¹ / ₂
FCF15	36 ³ / ₄	17	12 ¹ / ₂	35 ⁵ / ₈	20 ¹ / ₁₆	29 ¹ / ₈	16 ⁹ / ₁₆	25 ¹⁵ / ₁₆	3 ³ / ₈
FCF18	36 ⁵ / ₁₆	18 ⁷ / ₈	14	37 ³ / ₈	20 ¹ / ₁₆	29 ¹ / ₈	16 ⁹ / ₁₆	27	4 ¹ / ₈
FCF20	48 ⁹ / ₁₆	24 ³ / ₄	15 ³ / ₄	46 ³ / ₁₆	28	40 ⁷ / ₈	25 ¹ / ₄	32 ⁷ / ₁₆	4 ¹ / ₈
FCF22	50 ⁹ / ₁₆	27 ¹ / ₄	17 ¹ / ₈	47 ¹³ / ₁₆	28	40 ⁷ / ₈	25 ¹ / ₄	35 ¹ / ₂	2 ¹⁵ / ₁₆
FCF25	53 ¹ / ₁₆	31 ¹ / ₄	19 ⁵ / ₈	50 ⁵ / ₁₆	28	40 ⁷ / ₈	25 ¹ / ₄	39 ⁵ / ₈	4 ¹ / ₂

MODEL	N	O	P	S	T	V	WHEEL		EST. WEIGHT
							DIA.	WIDTH	
FCF10	³ / ₄	12	17 ³ / ₄	11 ³ / ₄	11 ¹ / ₁₆	—	11 ¹ / ₈	7 ³ / ₁₆	62
FCF12	³ / ₄	14	17 ³ / ₄	11 ³ / ₄	11 ¹ / ₁₆	—	12 ⁷ / ₈	7 ³ / ₁₆	68
FCF15	1	17	21 ¹ / ₈	11 ¹ / ₂	14 ¹ / ₁₆	15 ⁵ / ₈	15 ¹ / ₂	9 ⁹ / ₁₆	150
FCF18	1	18	21 ¹ / ₈	11 ¹ / ₂	14 ¹ / ₁₆	17 ¹ / ₈	18 ¹ / ₂	10 ¹³ / ₁₆	166
FCF20	1 ³ / ₁₆	21	27 ¹ / ₁₆	14 ⁵ / ₈	22 ¹ / ₂	18 ⁷ / ₈	20 ⁷ / ₁₆	10 ¹ / ₄	358
FCF22	1 ³ / ₁₆	22 ¹ / ₂	27 ¹ / ₁₆	14 ⁵ / ₈	22 ¹ / ₂	20 ¹ / ₄	22 ¹ / ₄	11 ¹ / ₄	390
FCF25	1 ³ / ₁₆	26 ³ / ₄	27 ¹ / ₁₆	14 ⁵ / ₈	22 ¹ / ₂	22 ¹ / ₄	25 ¹ / ₄	13	437

All dimensions are shown in inches.



Intertek

Utility Blowers

FCF Performance Data

FCF10

MODEL NUMBER	SHAFT DIAMETER	POWER RANGE	MAX RPM	TIP SPEED 2.91 X RPM = FPM
FCF10	¾"	2 HP	2000	

CAPACITY	OUTLET VELOCITY	¼" SP		½" SP		¾" SP		1" SP		1 ½" SP		2" SP		3" SP		4" SP		
		CFM	FPM	RPM	BHP	RPM	BHP	RPM	BHP	RPM	BHP	RPM	BHP	RPM	BHP	RPM	BHP	RPM
500	689	507	0.04															
600	827	536	0.05															
700	965	555	0.07	•714	•0.11													
800	1102	576	0.09	745	0.13	•858	•0.18											
900	1240	598	0.12	768	0.16	888	0.21	•984	•0.26									
1000	1378	623	0.15	787	0.21	918	0.25	1013	0.30									
1100	1516	661	0.19	808	0.25	940	0.30	1044	0.35	•1204	•0.48							
1200	1654	699	0.23	829	0.30	959	0.36	1071	0.41	1234	0.54							
1300	1791	739	0.28	853	0.36	980	0.43	1091	0.49	1264	0.61	•1399	•0.76					
1400	1929	779	0.34	876	0.42	1000	0.50	1111	0.57	1294	0.68	1429	0.85					
1500	2067	823	0.41	913	0.49	1023	0.58	1131	0.66	1318	0.78	1459	0.94					
1600	2205	867	0.48	952	0.57	1046	0.67	1151	0.75	1338	0.90	1490	1.04	•1716	•1.41			
1700	2343	913	0.56	990	0.66	1070	0.76	1174	0.86	1357	1.03	1516	1.16	1746	1.54			
1800	2480	958	0.66	1029	0.76	1105	0.86	1197	0.97	1378	1.16	1535	1.32	1776	1.67			
1900	2618	1004	0.76	1069	0.87	1143	0.98	1220	1.09	1398	1.30	1555	1.48	1806	1.82			
2000	2756	1050	0.87	1110	0.98	1181	1.10	1246	1.21	1419	1.45	1575	1.65	1837	1.97			
2200	3032	1144	1.14	1199	1.26	1259	1.39	1322	1.51	1465	1.77							
2400	3307	1240	1.46	1289	1.59	1339	1.72	1399	1.86									
2600	3583	1336	1.83	1380	1.97													

FCF12

MODEL NUMBER	SHAFT DIAMETER	POWER RANGE	MAX RPM	TIP SPEED 3.37 X RPM = FPM
FCF12	¾"	2 HP	1800	

CAPACITY	OUTLET VELOCITY	¼" SP		½" SP		¾" SP		1" SP		1 ½" SP		2" SP		3" SP		4" SP		
		CFM	FPM	RPM	BHP	RPM	BHP	RPM	BHP	RPM	BHP	RPM	BHP	RPM	BHP	RPM	BHP	RPM
700	813	424	0.05															
800	929	438	0.06															
900	1045	457	0.08	•592	•0.11													
1000	1161	476	0.10	601	0.14													
1100	1277	496	0.12	613	0.16	•725	•0.21											
1200	1393	518	0.14	634	0.19	734	0.24											
1300	1509	541	0.17	652	0.23	745	0.27	•837	•0.33									
1400	1625	565	0.20	670	0.27	762	0.32	849	0.38									
1500	1742	589	0.24	689	0.31	782	0.37	860	0.42									
1600	1858	612	0.28	711	0.35	800	0.42	877	0.48	•1026	•0.61							
1700	1974	635	0.32	734	0.41	818	0.48	897	0.55	1038	0.68							
1800	2090	659	0.37	757	0.46	836	0.54	915	0.62	1049	0.75	•1184	•0.91					
1900	2206	683	0.43	780	0.52	858	0.61	933	0.69	1061	0.82	1191	0.99					
2000	2322	708	0.48	803	0.59	880	0.68	951	0.77	1082	0.93	1203	1.08					
2200	2554	757	0.62	851	0.74	926	0.85	992	0.94	1120	1.13	1226	1.27	•1450	•1.67			
2400	2786	807	0.77	897	0.91	972	1.04	1037	1.14	1156	1.35	1268	1.56	1467	1.92			
2600	3019	857	0.96	945	1.11	1020	1.25	1083	1.37	1194	1.59	1304	1.83					
2800	3251	907	1.18	994	1.34	1066	1.49	1130	1.63	1238	1.88							
3000	3483	958	1.43	1043	1.59	1114	1.76	1177	1.92									
3200	3715	1009	1.71	1093	1.88													

• Indicates the approximate maximum static efficiency.

FCF Performance Data

FCF15

MODEL NUMBER	SHAFT DIAMETER	POWER RANGE	MAX RPM	TIP SPEED 4.06 X RPM = FPM
FCF15	1"	5 HP	1200	

CAPACITY	OUTLET VELOCITY	¼" SP		½" SP		¾" SP		1" SP		1 ½" SP		2" SP		3" SP		4" SP		
		CFM	FPM	RPM	BHP	RPM	BHP	RPM	BHP	RPM	BHP	RPM	BHP	RPM	BHP	RPM	BHP	RPM
1300	881	345	0.11															
1400	949	346	0.12															
1500	1016	353	0.13															
1600	1084	364	0.15															
1700	1152	375	0.17															
1800	1220	387	0.20															
1900	1287	400	0.22	•488	•0.32													
2000	1355	412	0.25	491	0.34													
2200	1491	430	0.31	507	0.41													
2400	1626	445	0.37	530	0.49	•598	•0.61											
2600	1762	460	0.44	555	0.58	611	0.70	•691	•0.88									
2800	1897	480	0.52	579	0.69	633	0.81	693	0.96									
3000	2033	501	0.61	599	0.80	657	0.94	705	1.08									
3200	2168	523	0.72	614	0.92	681	1.08	727	1.23	•846	•1.62							
3400	2304	545	0.83	629	1.05	706	1.24	751	1.39	846	1.74							
3600	2439	567	0.96	644	1.18	728	1.41	775	1.58	859	1.91							
3800	2575	590	1.10	662	1.34	743	1.58	799	1.77	876	2.11	•976	•2.57					
4000	2710	613	1.26	683	1.51	759	1.76	824	1.99	900	2.35	982	2.76					
4200	2846	636	1.43	705	1.69	773	1.96	844	2.21	924	2.61	995	3.00					
4400	2981	660	1.62	726	1.89	788	2.16	859	2.44	948	2.88	1013	3.27					
4600	3117	683	1.82	748	2.11	806	2.39	875	2.68	972	3.18	1037	3.59	•1196	•4.67			
4800	3252	707	2.05	770	2.34	827	2.64	889	2.94	997	3.49	1061	3.93	1196	4.90			
5000	3388	731	2.28	792	2.59	848	2.91	904	3.22	1022	3.83	1085	4.29					
5200	3523	755	2.54	815	2.86	869	3.19	919	3.51	1038	4.16	1109	4.67					
5400	3659	779	2.82	837	3.15	891	3.49	939	3.82	1053	4.51							
5600	3794	804	3.12	860	3.47	912	3.81	960	4.16	1069	4.87							
5800	3930	828	3.44	884	3.80	934	4.15	982	4.52									
6000	4065	853	3.78	907	4.16	956	4.52	1003	4.90									
6200	4201	878	4.15	930	4.54	978	4.90											
6400	4336	903	4.53	954	4.94													
6600	4472	929	4.95															

FCF18

MODEL NUMBER	SHAFT DIAMETER	POWER RANGE	MAX RPM	TIP SPEED 4.84 X RPM = FPM
FCF18	1"	5 HP	1200	

CAPACITY	OUTLET VELOCITY	¼" SP		½" SP		¾" SP		1" SP		1 ½" SP		2" SP		3" SP		4" SP		
		CFM	FPM	RPM	BHP	RPM	BHP	RPM	BHP	RPM	BHP	RPM	BHP	RPM	BHP	RPM	BHP	RPM
1300	708	282	0.10															
1400	763	289	0.11															
1500	817	295	0.13															
1600	872	302	0.15															
1700	926	308	0.17															
1800	981	315	0.19	•397	•0.27													
1900	1035	322	0.21	403	0.30													
2000	1090	328	0.23	409	0.33													
2200	1199	342	0.28	423	0.40	•487	•0.50											
2400	1308	357	0.33	436	0.47	498	0.58											
2600	1417	372	0.40	449	0.55	512	0.68	•563	•0.79									
2800	1526	388	0.47	463	0.63	525	0.79	577	0.92									
3000	1635	403	0.55	476	0.73	538	0.90	591	1.05									
3200	1744	420	0.64	490	0.83	551	1.02	604	1.19	•691	•1.47							
3400	1853	437	0.75	505	0.95	564	1.15	617	1.33	705	1.66							
3600	1962	454	0.86	520	1.08	578	1.28	630	1.49	718	1.86	•795	•2.18					
3800	2071	471	0.98	536	1.21	592	1.43	643	1.66	731	2.06	805	2.39					
4000	2180	488	1.12	551	1.37	606	1.59	657	1.83	744	2.27	819	2.65					
4200	2289	506	1.27	567	1.53	621	1.77	671	2.02	758	2.49	833	2.92					
4400	2398	524	1.43	583	1.70	636	1.97	685	2.22	771	2.73	845	3.19	•973	•3.99			
4600	2507	542	1.61	600	1.90	652	2.17	699	2.43	784	2.97	858	3.47	982	4.30			
4800	2616	560	1.80	617	2.10	667	2.39	714	2.67	798	3.23	871	3.76	996	4.68			
5000	2725	578	2.01	634	2.33	683	2.63	729	2.92	811	3.51	885	4.07					
5200	2834	596	2.23	651	2.56	699	2.88	744	3.19	825	3.79	898	4.39					
5400	2943	615	2.48	668	2.82	715	3.15	759	3.47	839	4.09	911	4.73					
5600	3052	633	2.73	686	3.09	732	3.44	775	3.77	853	4.41							
5800	3161	652	3.01	703	3.38	749	3.74	791	4.09	868	4.76							
6000	3270	670	3.31	721	3.68	766	4.07	807	4.42									
6200	3379	689	3.62	739	4.01	783	4.41	823	4.78									
6400	3488	708	3.95	757	4.35	800	4.77											
6600	3597	727	4.31	775	4.73													
6800	3706	746	4.68															

• Indicates the approximate maximum static efficiency.

FCF Performance Data

FCF20

MODEL NUMBER	SHAFT DIAMETER	POWER RANGE	MAX RPM	TIP SPEED
FCF20	1 3/8"	10 HP	1100	5.35 X RPM = FPM

CAPACITY	OUTLET VELOCITY	1/4" SP		1/2" SP		3/4" SP		1" SP		1 1/2" SP		2" SP		3" SP		4" SP		
		CFM	FPM	RPM	BHP	RPM	BHP	RPM	BHP	RPM	BHP	RPM	BHP	RPM	BHP	RPM	BHP	RPM
1300	573	258	0.09															
1400	617	•258	•0.10															
1500	661	258	0.11															
1600	705	259	0.12															
1700	749	260	0.13															
1800	793	261	0.14															
1900	837	264	0.15															
2000	881	266	0.17	•365	•0.29													
2200	969	272	0.20	366	0.32													
2400	1057	280	0.23	368	0.36	•447	•0.52											
2600	1145	288	0.27	371	0.41	447	0.57	517	0.75									
2800	1233	297	0.32	376	0.47	449	0.63	•516	•0.80									
3000	1322	305	0.37	381	0.52	451	0.69	516	0.87									
3200	1410	314	0.42	387	0.59	455	0.76	518	0.95									
3400	1498	325	0.48	396	0.66	460	0.84	520	1.03	•632	•1.46							
3600	1586	336	0.55	404	0.74	465	0.93	523	1.12	632	1.55							
3800	1674	347	0.63	413	0.83	470	1.02	528	1.23	634	1.67	730	2.18					
4000	1762	358	0.72	421	0.92	478	1.12	533	1.34	636	1.79	•729	•2.29					
4200	1850	370	0.81	430	1.01	486	1.24	538	1.45	638	1.92	730	2.42					
4400	1938	381	0.91	439	1.12	495	1.36	543	1.57	640	2.05	732	2.59					
4600	2026	393	1.02	448	1.23	503	1.48	551	1.71	645	2.21	734	2.75	895	3.97			
4800	2115	406	1.13	459	1.36	512	1.62	559	1.86	650	2.38	736	2.91	894	4.13			
5000	2203	418	1.26	470	1.50	520	1.76	568	2.02	655	2.55	738	3.08	•893	•4.29			
5200	2291	431	1.40	481	1.65	529	1.90	576	2.19	660	2.72	742	3.28	894	4.52	1033	5.99	
5400	2379	444	1.54	492	1.81	538	2.06	585	2.36	666	2.90	747	3.50	896	4.76	1032	6.21	
5600	2467	456	1.70	503	1.98	547	2.22	593	2.54	673	3.11	752	3.72	898	5.01	1032	6.42	
5800	2555	469	1.86	515	2.16	558	2.42	602	2.73	682	3.34	757	3.95	900	5.25	•1031	•6.63	
6000	2643	482	2.04	526	2.34	569	2.62	611	2.93	690	3.57	762	4.19	902	5.50	1033	6.95	
6200	2731	495	2.23	538	2.54	580	2.84	620	3.13	698	3.81	768	4.43	905	5.76	1035	7.28	
6400	2819	508	2.43	549	2.76	591	3.07	629	3.35	707	4.06	775	4.69	910	6.08	1037	7.60	
6600	2907	522	2.64	562	2.98	602	3.31	639	3.60	715	4.32	783	4.99	915	6.41	1039	7.93	
6800	2996	535	2.86	574	3.22	613	3.56	650	3.86	724	4.59	791	5.29	920	6.74	1041	8.26	
7000	3084	548	3.10	587	3.47	625	3.82	661	4.14	733	4.87	800	5.61	925	7.08	1043	8.59	
7500	3304	581	3.75	619	4.15	653	4.53	688	4.89	755	5.61	821	6.44	938	7.96	1053	9.60	
8000	3524	615	4.50	651	4.93	683	5.33	716	5.73	778	6.45	843	7.34	955	8.98			
8500	3744	649	5.34	683	5.79	714	6.23	745	6.66	805	7.45	865	8.31					
9000	3965	683	6.29	716	6.76	746	7.23	774	7.68	833	8.56	887	9.36					
9500	4185	717	7.34	749	7.83	778	8.34	805	8.82	861	9.76							
10000	4405	752	8.51	782	9.01	810	9.56											
10500	4626	786	9.80															

FCF22

MODEL NUMBER	SHAFT DIAMETER	POWER RANGE	MAX RPM	TIP SPEED
FCF22	1 3/8"	10 HP	1100	5.79 X RPM = FPM

CAPACITY	OUTLET VELOCITY	1/4" SP		1/2" SP		3/4" SP		1" SP		1 1/2" SP		2" SP		3" SP		4" SP		
		CFM	FPM	RPM	BHP	RPM	BHP	RPM	BHP	RPM	BHP	RPM	BHP	RPM	BHP	RPM	BHP	RPM
1800	555	237	0.14															
1900	586	239	0.15															
2000	617	240	0.16															
2200	679	244	0.19															
2400	741	250	0.22															
2600	802	256	0.25	•336	•0.41													
2800	864	261	0.28	339	0.46													
3000	926	267	0.32	342	0.51	•409	•0.70											
3200	987	274	0.36	348	0.56	412	0.76											
3400	1049	283	0.41	353	0.62	415	0.83											
3600	1111	291	0.46	359	0.68	418	0.90	•474	•1.13									
3800	1172	299	0.52	365	0.74	423	0.98	477	1.22									
4000	1234	308	0.59	371	0.81	428	1.06	480	1.31									
4200	1296	317	0.65	377	0.88	434	1.15	483	1.41									
4400	1358	325	0.73	383	0.96	440	1.25	488	1.51	•581	•2.08							
4600	1419	334	0.81	391	1.05	446	1.34	494	1.63	584	2.21							
4800	1481	343	0.89	399	1.15	451	1.44	500	1.75	587	2.35							
5000	1543	352	0.99	407	1.26	457	1.55	505	1.87	589	2.48	•670	•3.13					
5200	1604	361	1.09	416	1.37	463	1.66	511	1.99	593	2.63	672	3.30					
5400	1666	370	1.20	424	1.49	469	1.77	517	2.12	598	2.79	675	3.48					
5600	1728	379	1.31	433	1.62	477	1.91	523	2.26	604	2.96	678	3.66					
5800	1790	388	1.43	442	1.75	486	2.06	529	2.40	610	3.14	681	3.85					
6000	1851	398	1.56	450	1.89	494	2.22	535	2.55	615	3.32	684	4.04	•818	•5.58			
6200	1913	407	1.70	459	2.04	502	2.38	541	2.70	621	3.50	690	4.26	821	5.85			
6400	1975	417	1.85	468	2.19	511	2.55	549	2.88	627	3.69	696	4.48	824	6.11			
6600	2036	426	2.00	477	2.36	519	2.73	557	3.07	633	3.89	701	4.71	827	6.38			
6800	2098	436	2.16	486	2.54	528	2.92	565	3.28	639	4.09	707	4.95	830	6.65			
7000	2160	445	2.33	495	2.73	536	3.11	573	3.49	645	4.30	713	5.19	833	6.93			
7500	2314	469	2.80	517	3.24	558	3.64	594	4.06	659	4.85	727	5.83	842	7.67	•946	•8.72	
8000	2468	494	3.33	540	3.81	580	4.22	616	4.68	678	5.52	742	6.50	857	8.51	953	9.60	
8500	2623	519	3.92	563	4.44	602	4.90	637	5.37	699	6.29	757	7.22	871	9.41			
9000	2777	544	4.58	587	5.14	625	5.65	659	6.12	720	7.12	774	8.05					
9500	2931	570	5.32	610	5.92	648	6.47	682	6.96	741	8.03	794	9.03					
10000	3085	596	6.13	634	6.77	671	7.36	704	7.90	763	9.00							
10500	3240	621	7.03	659	7.71	694	8.34	726	8.92									
11000	3394	647	8.01	683	8.72	717	9.40											
11500	3548	674	9.08	708	9.83													

• Indicates the approximate maximum static efficiency.

FCF Performance Data

FCF25

MODEL NUMBER	SHAFT DIAMETER	POWER RANGE	MAX RPM	TIP SPEED
FCF25	1 3/16"	10 HP	1000	6.61 X RPM = FPM

CAPACITY	OUTLET VELOCITY	1/4" SP		1/2" SP		3/4" SP		1" SP		1 1/2" SP		2" SP		3" SP		4" SP		
		CFM	FPM	RPM	BHP	RPM	BHP	RPM	BHP	RPM	BHP	RPM	BHP	RPM	BHP	RPM	BHP	RPM
3000	704	215	0.23	296	0.46													
3200	751	218	0.25	296	0.49													
3400	798	221	0.28	297	0.51													
3600	845	225	0.32	298	0.53													
3800	892	229	0.36	•299	•0.55	362	0.87											
4000	939	233	0.40	301	0.58	363	0.90											
4200	986	238	0.44	303	0.63	364	0.94	419	1.30									
4400	1033	242	0.49	306	0.67	365	0.97	418	1.35									
4600	1080	246	0.54	309	0.72	366	1.00	419	1.39									
4800	1127	250	0.59	313	0.79	•367	•1.04	420	1.43									
5000	1174	255	0.64	317	0.87	370	1.10	421	1.47									
5200	1221	260	0.70	321	0.94	372	1.17	422	1.51	512	2.40							
5400	1268	264	0.76	325	1.02	375	1.24	•423	•1.56	512	2.48							
5600	1315	269	0.82	329	1.11	378	1.31	425	1.62	513	2.54							
5800	1362	273	0.89	333	1.19	382	1.41	427	1.71	514	2.60							
6000	1409	278	0.96	337	1.28	386	1.52	430	1.80	515	2.66	592	3.70					
6200	1456	283	1.03	341	1.38	390	1.63	433	1.89	516	2.73	591	3.80					
6400	1503	288	1.11	346	1.47	394	1.75	435	1.99	517	2.79	592	3.88					
6600	1550	293	1.19	350	1.57	398	1.87	439	2.11	518	2.85	593	3.97					
6800	1597	298	1.27	354	1.68	402	2.00	443	2.25	•519	•2.94	594	4.05					
7000	1644	303	1.37	359	1.78	406	2.12	447	2.40	522	3.07	595	4.13					
7500	1761	317	1.64	370	2.07	416	2.46	457	2.78	529	3.41	•597	•4.34	724	6.91			
8000	1878	331	1.95	382	2.38	427	2.83	467	3.20	536	3.78	602	4.65	726	7.24			
8500	1996	345	2.28	394	2.72	438	3.22	477	3.64	546	4.32	608	5.11	728	7.55			
9000	2113	360	2.63	406	3.09	449	3.64	488	4.12	556	4.89	615	5.58	731	7.86			
9500	2231	375	3.02	418	3.49	461	4.09	499	4.62	566	5.50	624	6.20	•733	•8.18			
10000	2348	390	3.44	431	3.98	473	4.58	510	5.16	576	6.14	634	6.93	739	8.82			
10500	2465	405	3.90	445	4.52	484	5.10	521	5.73	586	6.82	644	7.70	746	9.51			
11000	2583	420	4.41	459	5.11	496	5.65	533	6.33	597	7.53	654	8.52					
11500	2700	436	4.96	474	5.74	509	6.25	545	6.98	608	8.28	664	9.37					
12000	2818	451	5.55	488	6.42	522	6.94	556	7.67	619	9.07							
12500	2935	466	6.18	502	7.11	535	7.72	568	8.40	630	9.90							
13000	3052	481	6.86	517	7.85	549	8.55	580	9.17									
13500	3170	496	7.58	532	8.64	563	9.44	593	9.99									
14000	3287	512	8.36	547	9.48													
14500	3405	527	9.19															

• Indicates the approximate maximum static efficiency.