



Direct Drive Upblast Roof Exhauster Model UD

Model UD low silhouette direct drive upblast exhausters are ideally suited for moving large volumes of air at low static pressures. Capacities up to 25,130 CFM and up to 1/2 inch static pressure. The UD is designed to discharge air up and away from the building. Typical applications include all types of commercial, and industrial facilities such as warehouses, foundries, mills and manufacturing plants.



Construction Features

Windband

- Constructed of heavy gauge steel with a rolled flange for extra strength
- Channel cross tie member provides lateral rigidity

Butterfly Dampers

- Constructed of heavy gauge aluminum
- Stainless steel hinge pins and nylon bearings provide quiet, low friction operation
- Dampers open and close against rubber bumpers for quiet operation
- Magnetic latches ensure positive closure and prevent damper chatter
- Water trough under damper hinge provides drainage for rain, melting snow and ice

Aluminum Propeller

- Constructed of welded heavy gauge aluminum
- High efficiency circular arc airfoil blade design
- Precision balanced for smooth vibration free operation

Housing

- Heavy gauge steel base with deep drawn orifice
- Steel structural frame carries the weight of motor, fan and drive assembly on sizes 42" and 48"

Motor

- Continuous duty motors by nationally recognized manufacturers

Options/Accessories

- Roof Curbs
- Disconnect Switches
- Outlet Guard
- Coatings
- Fusible Heat Release Damper Link
- Aluminum Windband and Housing

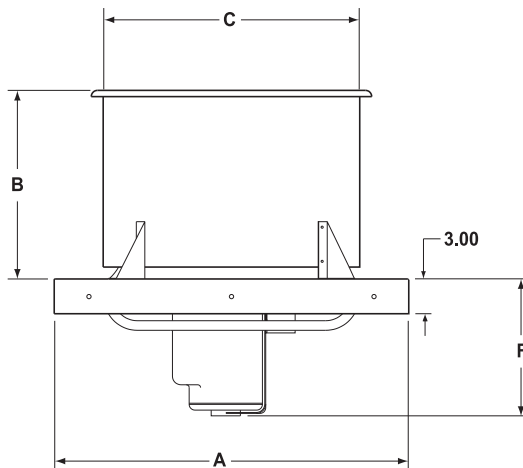

DIMENSIONS

Fan Model	A	B	C	F	Roof Opening*	Curb Model
UD18	31.00	16.50	22.50	12.00	26.5 x 26.5	C29.5
UD21	34.00	19.00	26.25	14.25	29.5 x 29.5	C32.5
UD24	38.00	21.00	30.00	14.88	33.5 x 33.5	C36.5
UD30	46.00	26.25	37.50	16.38	41.5 x 41.5	C44.5
UD36	52.50	31.50	45.00	15.25	48 x 48	C51
UD42	60.00	36.00	52.50	19.50	55.5 x 55.5	C58.5
UD48	64.00	38.00	60.00	19.50	59.5 x 59.5	C62.5

Dimensions are shown in inches.

*Recommended maximum

Acme Engineering & Manufacturing Corporation certifies that the models shown herein are licensed to bear the AMCA Seal. The ratings shown are based on tests and procedures performed in accordance with AMCA Publication 211 and AMCA Publication 311 and comply with the requirements of the AMCA Certified Ratings Program.

U.L. 705 Listed

Consult your Acme representative for availability.

Propeller Roof Fans

PERFORMANCE DATA												
Fan Model	HP	RPM	Tip Speed	Max. Sones	CFM vs. Static Pressure						Max. BHP	Ship Wts.
					.000"	.100"	.125"	.250"	.375"	.500"		lbs.
UD18C6	1/8	1160	5460	14	2730						.14	111
UD18D6	1/6	1160	5460	14	3020	2560					.19	124
UD18E4	1/4	1760	8290	26	3250	3100	3050	2730			.30	111
UD18F4	1/3	1760	8290	23	3760	3540	3490	3100			.40	114
UD18G4	1/2	1760	8290	27	4290	4120	4060	3720			.59	122
UD21F6	1/3	1160	6370	19	4520	4110	3980				.37	173
UD21G4	1/2	1760	9670	28	5230	4990	4920	4580			.58	163
UD21H4	3/4	1760	9670	29	6160	5870	5800	5420			.88	161
UD21J4	1	1760	9670	31	6530	6270	6190	5810			1.04	199
UD24G6	1/2	1160	7280	20	6230	5760	5630	4880			.54	243
UD24H6	3/4	1160	7280	23	7180	6680	6530	5680			.81	266
UD24J4	1	1760	11050	37	7790	7530	7480	7100			1.13	266
UD24K4	1 1/2	1760	11050	39	9230	8890	8800	8370			1.68	271
UD24L4	2	1760	11050	39	10340	10000	9940	9500			2.26	276
UD30H8	3/4	860	6750	20	9920	9040	8820	7380			.77	375
UD30J8	1	860	6750	23	10880	9980	9740	8330			1.07	375
UD30H6	3/4	1160	9110	39	9240	8750	8620	7970			.78	365
UD30J6	1	1160	9110	29	10660	10100	9960	9200			1.04	370
UD30K6	1 1/2	1160	9110	37	13100	12390	12220	11370			1.72	375
UD30L6	2	1160	9110	38	14400	13700	13500	12610			2.24	424
UD36J8	1	860	8100	32	13980	13080	12800	11500			1.15	541
UD36K8	1 1/2	860	8100	33	16600	15650	15400	14040			1.70	548
UD36L8	2	860	8100	36	18490	17400	17130	15600			2.23	555
UD36L6	2	1160	10930	44	17000	16370	16200	15250			2.09	541
UD36M6	3	1160	10930	53	20390	19700	19530	18600			3.13	555
UD42K8	1 1/2	860	9460	35	17000	15900	15700	14200			1.72	616
UD42L8	2	860	9460	33	18600	17400	17100	15600			2.03	626
UD42M8	3	860	9460	43	23300	22100	21800	20400			3.43	636
UD48K8	1 1/2	860	10810	36	16870	15380	15040	13440	11830	10270	1.61	654
UD48L8	2	860	10810	39	19860	18610	18290	16610	14860	13080	2.02	664
UD48M8	3	860	10810	41	25130	23950	23660	22140	20520	18702	3.04	674

Performance certified is for Installation Type A: Free Inlet, Free Outlet. Performance ratings do not include the effects of appurtenances (accessories). Speed (RPM) shown is nominal. Performance is based on actual speed of test. The brake horsepower capability of an exhaustor motor is dependent on the degree of cooling the motor receives from the air moving through the motor. The above motor loadings do not overheat the motor and are in accordance with the motor manufacturer's recommendations. It is, therefore, not detrimental to the motor and economically desirable. The sound ratings shown are loudness values in hemispherical sones at 1.5 m (5 ft) in a hemispherical free field calculated per AMCA Standard 301. Values shown are for Installation Type A: Free Inlet hemispherical sone levels.

Propeller Roof Fans

For more information on this product contact your sales support.

